

## 5815F Floor Spring with 90 Degree Hold Open

**Description:** Door Closers

**Application:** Please note that Hager International products are not ANSI certified nor available for purchase in the United States. For ANSI-certified products, please click on 'Products' in the header above.



Overall Dimensions	- 307 (l) x 108 (w) x 40 (h) mm
	- 12.09 (l) x 4.25 (w) x 1.58 (h) in
Door Width	- 950 mm (37.40 in) maximum
Door Weight	- 105 kg (231.49 lbs)

Material	- Cast iron
Cover Finish	- US32D
Parts & Accessories	- Stainless steel cover plate and machine screws
Warranty	- Five-year
Notes	- Reversible/non-handed and adjustable latching and closing speeds

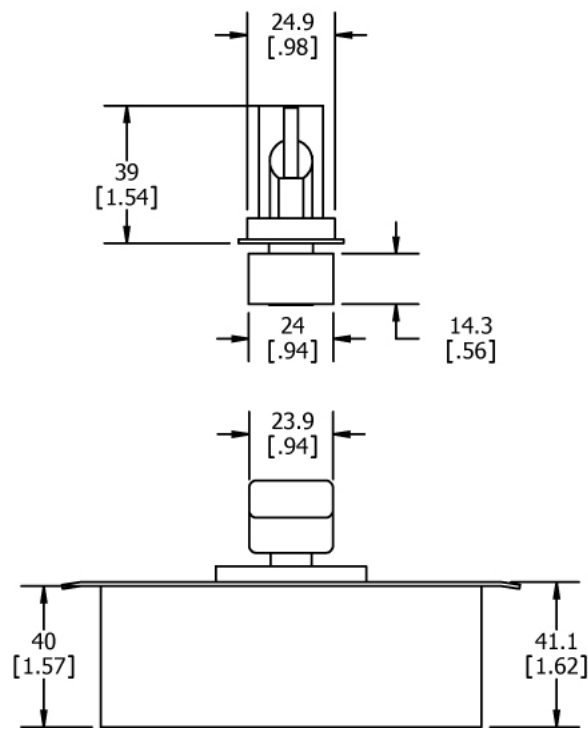
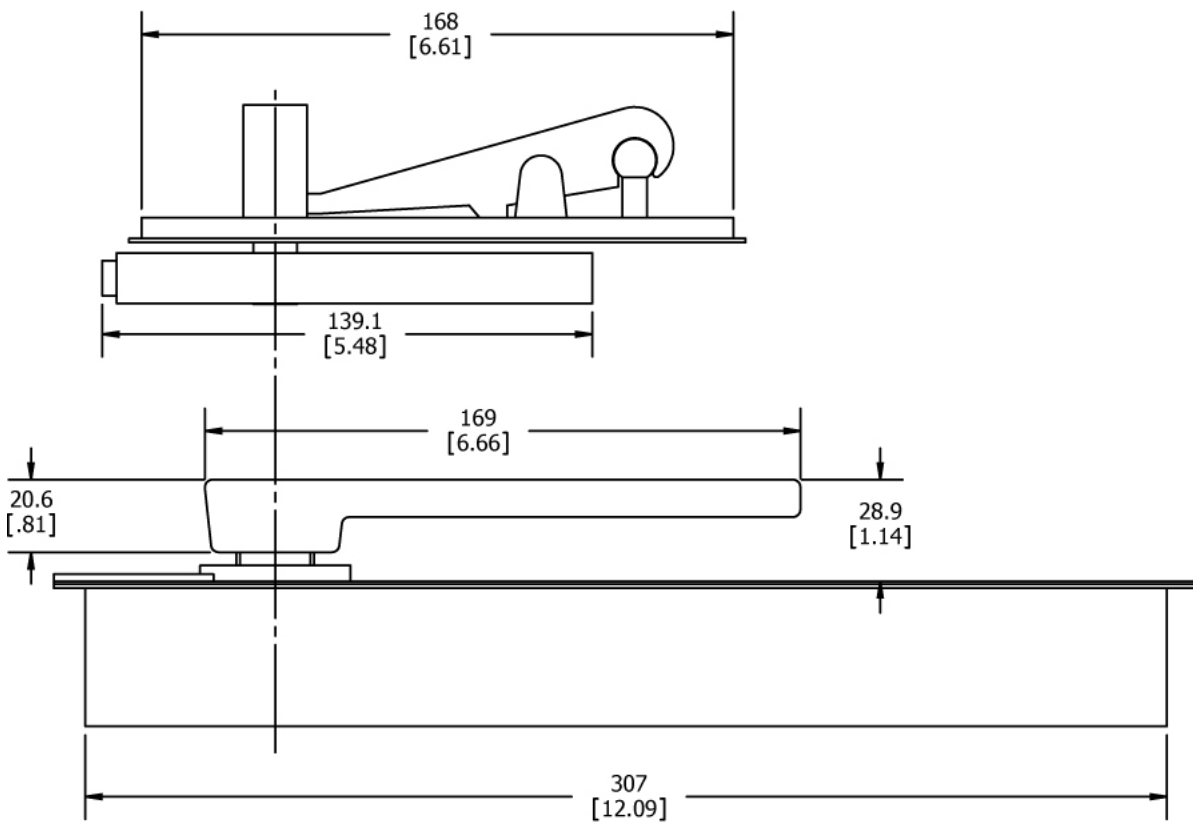



## Data and Features - EU Floor Spring with 90° Hold Open - 5815F

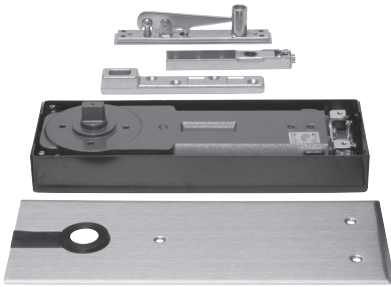

### Material:

Body Construction: Cast Iron

### Variable Closing Force:

Spring Strength: EN Std. 3

### Standard Doors:

Door Width: 950 mm / 37.4 in

Door Weight: 105 kg / 231.48 lbs

### Body Dimensions:

Length: 306 mm / 12.05 in

Width: 108 mm / 4.25 in

Height: 40 mm / 1.57 in

### Angle of Opening:

90° in each direction

### Power Adjustable By Spring:

No

### Power Adjustable By Position:

No

### Closing and Latching Speed Adjustments:

Sweep (Closing) Speed Adjustable (90° - 15°): Yes

Latching Speed Adjustable (15° - 0°): Yes

### Hold Open:

Built In: Yes

Hold Open Arm: No

### Back-Check:

Self Regulating: No

Adjustable at Valve: No

### Parts and Accessories:

Stainless Steel Cover: US32D Finish

Machine Screws: Included

### Non-Handed:

Yes

### Warranty:

5-Year