

Belton Foyer Pendant

5127803 | 1.0

GENERATION LIGHTING PENDANT

GENERAL PRODUCT INFORMATION:

These fixtures are intended to be installed utilizing NEC compliant junction boxes.

This product is safety listed for damp locations.

Incandescent version may be dimmed with a standard incandescent dimmer. LED version may be dimmed with a LED dimmer. Consult lamp manufacturer for additional information.

This instruction shows a typical installation.

SAVE THESE INSTRUCTIONS!

CAUTION - RISK OF FIRE

This product must be installed in accordance with the applicable installation code by a person familiar with the construction and operation of the product and the hazards involved.

Use minimum 90°C supply conductors.

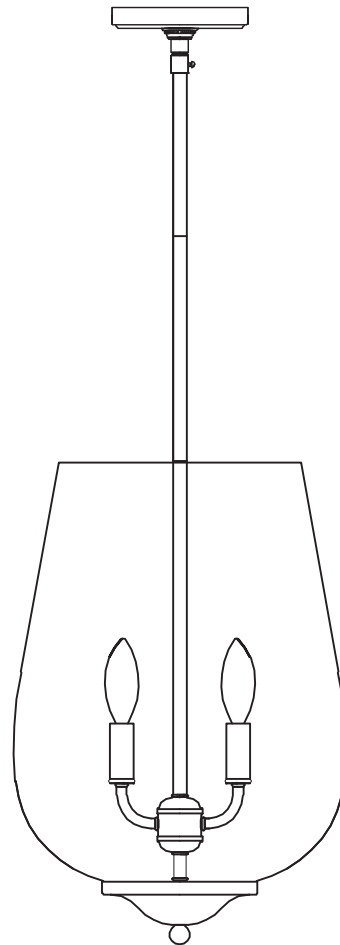
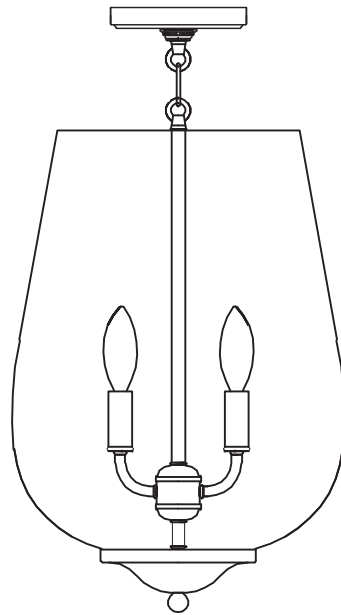

GENERATION LIGHTING
7400 Linder Ave., Skokie, IL 60077
T 847.410.4400 | F 847.410.4500
www.generationlighting.com

Install the Fixture

1A

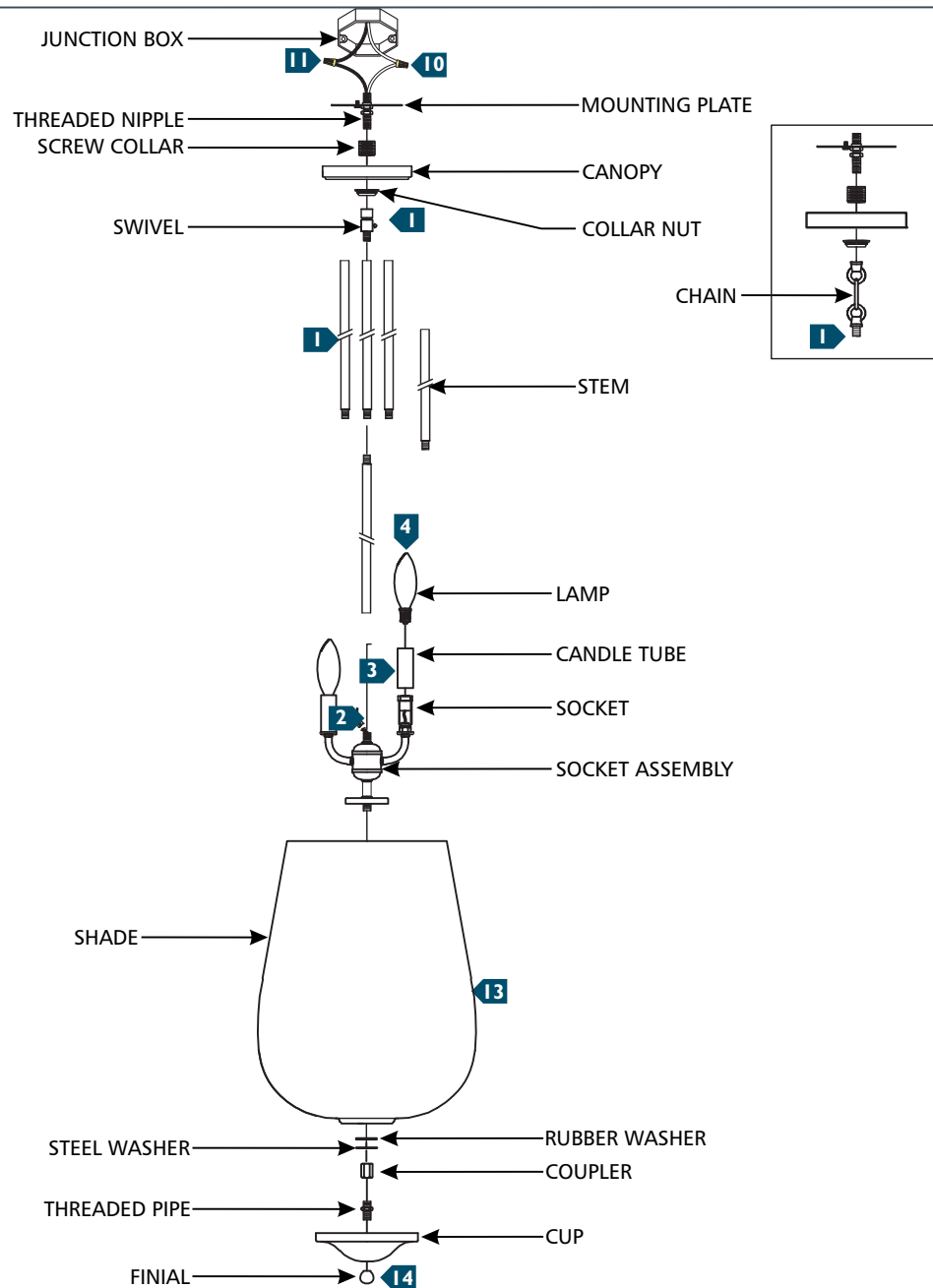

- 1** Determine the wanted height or look of the fixture with the provided stems, swivel, and/or chain and assemble them by screwing them together. All the parts may be used alone or used in combination.
- 2** Feed the fixture wires through the stems/chain and screw the assembly to the socket assembly.
- 3** Install the candle tubes by sliding them over the socket.
- 4** Screw the lamps into the sockets. Refer to the label on the socket for Max Wattage Information.
- 5** Unscrew the collar nut off the screw collar and place it onto the stem/chain followed by the canopy.
- 6** Screw the screw collar onto the threaded nipple.
- 7** Feed the fixture wires through the threaded nipple and screw the mounting plate assembly onto the stem/chain assembly.
- 8** Align and secure the mounting plate to the junction box.
- 9** Connect the fixture to a suitable ground in accordance to local electrical codes.
- 10** Connect the white fixture wire (square and/or rigid) to the neutral power line wire with a wire nut.
- 11** Connect the black fixture wire (round and/or smooth) to the hot power line wire with a wire nut.
- 12** Neatly place all the wires into the junction box, place the canopy onto the ceiling, and secure it in place by screwing the collar nut tightly onto the screw collar.
- 13** Place the shade, rubber washer, and steel washer onto the nipple on the bottom of the socket assembly and secure them by screwing on the coupler.
- 14** Screw the threaded pipe to the coupler, place the cup onto the threaded pipe, and secure it in place by screwing on the finial.