

## Serie Milano

89KIT10

Shower Kit 10

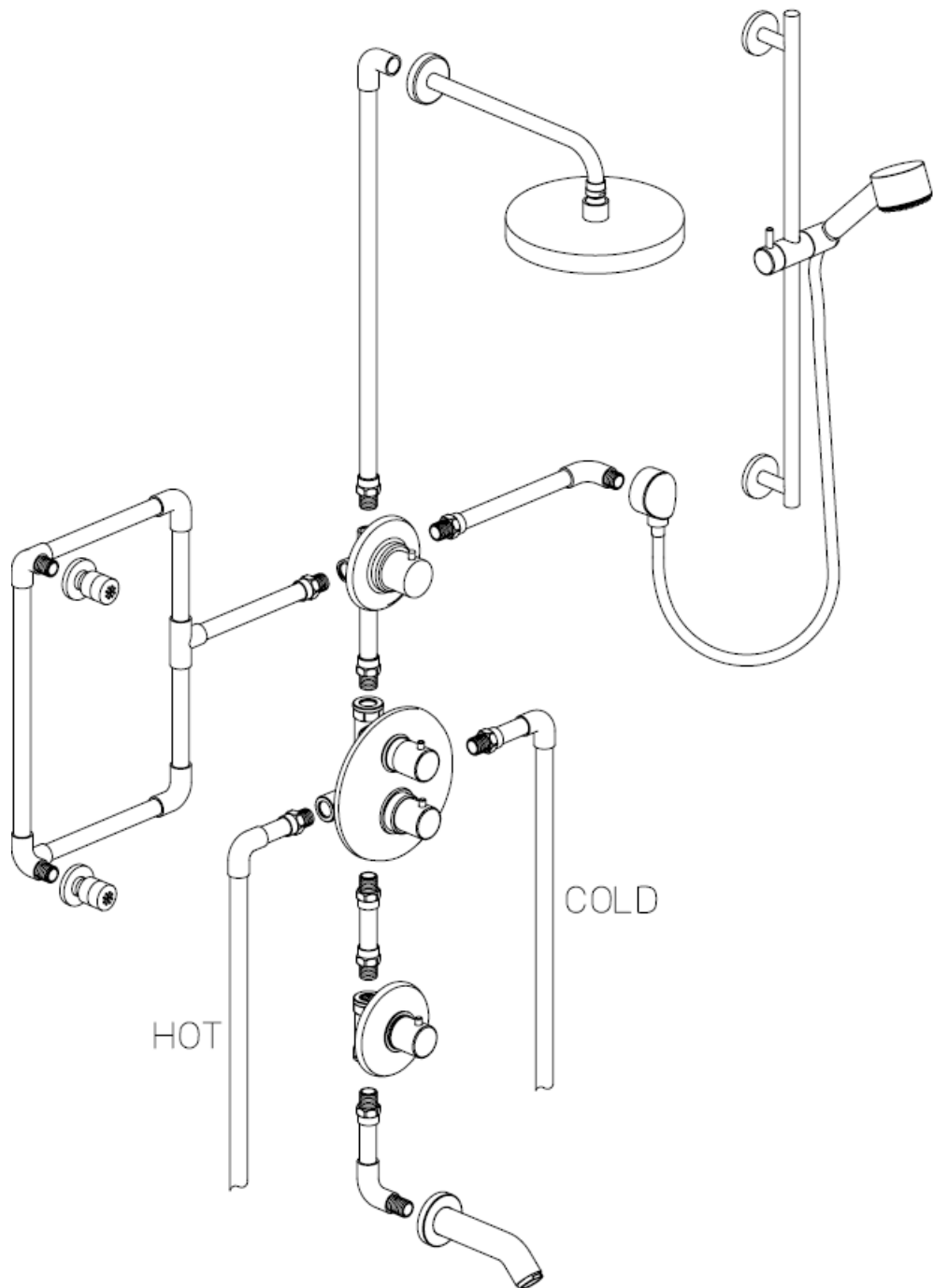

## Serie Milano

7812900

Adjustable Slidebar Handshower Set

### STANDARDS

- Compliant with ASME A112.18.1-B125.1 requirements
- Certified By CSA international

| <b>Finishes</b> | 7812900PC | 7812900BN |
|-----------------|-----------|-----------|
| Polished Chrome | X         |           |
| Brushed Nickel  |           | X         |

| <b>Features</b>  | 7812900PC | 7812900BN |
|--|-----------|-----------|
| 24" Adjustable Brass Slide Bar                         | X         | X         |
| Hand Shower with Dual Check Valves                     | X         | X         |
| Back Flow Prevention System                            | X         | X         |
| Includes: Hand Shower, Hose, Slide Bar, and Drop Elbow | X         | X         |
| 60" Hose with Matching Finish                          | X         | X         |
| Self Cleaning Spray Head                               | X         | X         |
| Step By Step Installation Instructions                 | X         | X         |
| Limited Lifetime Warranty                              | X         | X         |

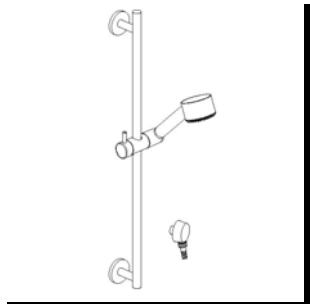

Project: \_\_\_\_\_  
 Contractor: \_\_\_\_\_

## Serie Milano

7875000

Showerhead Kit

### STANDARDS

- Compliant with ASME A112.18.1-B125.1
- Certified by CSA International

| <b>Finishes</b> | 7875000PC | 7875000BN |
|-----------------|-----------|-----------|
| Polished Chrome | X         |           |
| Brushed Nickel  |           | X         |

| <b>Features</b>   | 7875000PC | 7875000BN |
|---|-----------|-----------|
| Raincan Showerhead Kit with Matching 12" arm and flange | X         | X         |
| Delivers 2.5gpm at 80psi MAX                            | X         | X         |
| Showerhead features Rotating Ball Joint                 | X         | X         |
| 1/2" NPT Inlets   | X         | X         |
| Self Cleaning Spray Nozzles                             | X         | X         |
| Step-By-Step Installation Instructions                  | X         | X         |
| Limited Lifetime Warranty                               | X         | X         |

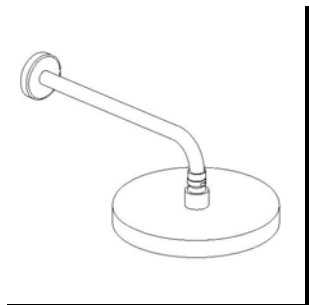

Project: \_\_\_\_\_  
 Contractor: \_\_\_\_\_

## Serie Milano

7872100

Body Spray

### STANDARDS

- Compliant with ASME A112.18.1-B125.1
- Certified by CSA International

| <b>Finishes</b> | 7872100PC | 7872100BN |
|-----------------|-----------|-----------|
| Polished Chrome | X         |           |
| Brushed Nickel  |           | X         |

| <b>Features</b>                        | 7872100PC | 7872100BN |
|--|-----------|-----------|
| Invigorating Body Jet                  | X         | X         |
| Delivers 2.5gpm at 80psi MAX           | X         | X         |
| Sprayer features 30° Rotation          | X         | X         |
| 1/2" NPT Inlets                        | X         | X         |
| Self Cleaning Spray Nozzles            | X         | X         |
| Step-By-Step Installation Instructions | X         | X         |
| Limited Lifetime Warranty              | X         | X         |

Project: \_\_\_\_\_  
 Contractor: \_\_\_\_\_

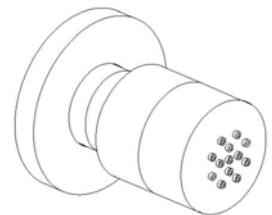

## Serie Milano

### 7869000

1/2" Thermostatic Valve with  
Volume Control trim only

### STANDARDS

- Compliant with ASME A112.18.1-B125.1
- Compliant with ASSE 1016
- Certified by CSA International

| <b>Finishes</b> | 7869000PC | 7869000BN |
|-----------------|-----------|-----------|
| Polished Chrome | X         |           |
| Brushed Nickel  |           | X         |

| <b>Features</b>   | 7869000PC | 7869000BN |
|---|-----------|-----------|
| Solid Brass Construction                                | X         | X         |
| 1/2" Stacked Thermostatic Valve Featuring Ceramic Discs | X         | X         |
| High Flow Valve Supports Multiple Outlets               | X         | X         |
| Kit Includes Trim and Thermostatic cartridge            | X         | X         |
| 1/2" NPT Inlets   | X         | X         |
| Progressive Volume Control                              | X         | X         |
| Independent Temperature Control                         | X         | X         |
| Step-By-Step Installation Instructions                  | X         | X         |
| Limited Lifetime Warranty                               | X         | X         |

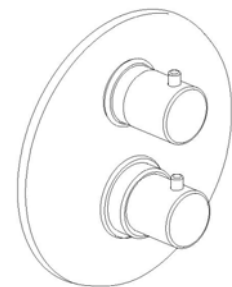

Project: \_\_\_\_\_  
Contractor: \_\_\_\_\_

## Serie Milano

7843000

Tub Spout

### STANDARDS

- Comply with ASME A112.18.1-B125.1 requirements
- Certified By CSA international

| <i><b>Finishes</b></i> | 7843000PC | 7843000BN |
|------------------------|-----------|-----------|
| Polished Chrome        | X         |           |
| Brushed Nickel         |           | X         |

| <i><b>Features</b></i>                 | 7843000PC | 7843000BN |
|--|-----------|-----------|
| Solid Brass Construction               | X         | X         |
| ½" NPT inlet connector                 | X         | X         |
| Non-Diverting, Polished Tub Spout      | X         | X         |
| Step by Step Installation Instructions | X         | X         |
| Limited Lifetime Warranty              | X         | X         |

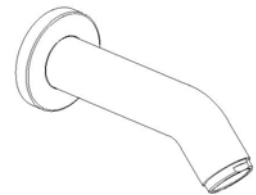

Project: \_\_\_\_\_

Contractor: \_\_\_\_\_

## Serie Milano

7842500

3 Way Diverter Valve trim only

### STANDARDS

- Compliant with ASME A112.18.1-B125.1 requirements
- Certified By CSA international

| <b>Finishes</b> | 7842500PC | 7842500BN |
|-----------------|-----------|-----------|
| Polished Chrome | X         |           |
| Brushed Nickel  |           | X         |

| <b>Features</b>  | 7842500PC | 7842500BN |
|--|-----------|-----------|
| Solid Brass Construction                                   | X         | X         |
| Ceramic Disc Valving                                       | X         | X         |
| 1/2" NPT Inlet   | X         | X         |
| 1 Inlet, 3 Outlets   | X         | X         |
| Select Individual Or Shared Outlet Positioning             | X         | X         |
| 3 Shared Positions For Activating 2 Outlets Simultaneously | X         | X         |
| Kit Includes Trim  | X         | X         |
| Step-By-Step Installation Instructions                     | X         | X         |
| Limited Lifetime Warranty                                  | X         | X         |

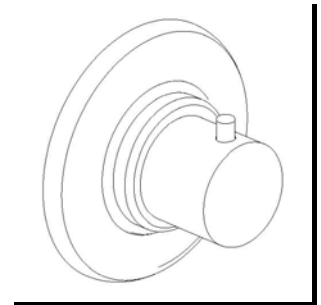

Project: \_\_\_\_\_  
 Contractor: \_\_\_\_\_

## Serie Milano

### 7840200

Trim for 1/2" & 3/4" Volume control

### STANDARDS

- Compliant with ASME A112.18.1-B125.1 requirements
- Certified By CSA international

| <b>Finishes</b> | 7840200PC | 7840200BN |
|-----------------|-----------|-----------|
| Polished Chrome | X         |           |
| Brushed Nickel  |           | X         |

| <b>Features</b>                        | 7840200PC | 7840200BN |
|--|-----------|-----------|
| Solid Brass Construction               | X         | X         |
| Ceramic Disc Valving                   | X         | X         |
| 3/4" NPT or 1/2" NPT inlet             | X         | X         |
| Progressive Volume Control             | X         | X         |
| Kit Includes Trim                      | X         | X         |
| Step-By-Step Installation Instructions | X         | X         |
| Limited Lifetime Warranty              | X         | X         |

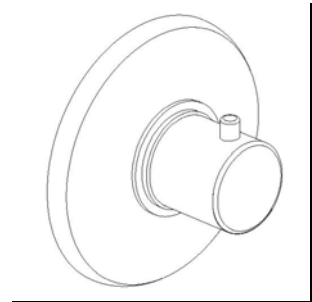

Project: \_\_\_\_\_  
 Contractor: \_\_\_\_\_