

FOREMOST

Berkshire Medicine Cabinet

Model Number: **BECC2330**

UPC: **721015345046**

Specifications:

- Shaker style with espresso finish
- Oil rubbed hardware
- Beveled mirror door
- 3 Interior adjustable shelves
- Secure-Mount™ Hanging System for easy mounting and leveling
- Door can be mounted for left or right swing
- Assembled

Overall Dimensions:

23 ⁵/₈ W x 7 D x 30 ¹/₈ H

Shipping:

GW 42.1 lbs

Construction & Materials:

- Core Materials: Engineered Wood, Wood

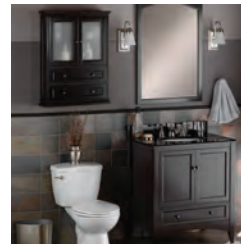

Download Collection Images

[High-Res](#)

[Low-Res](#)

Resources

[Register Your Warranty](#)

[Installation Manual](#)

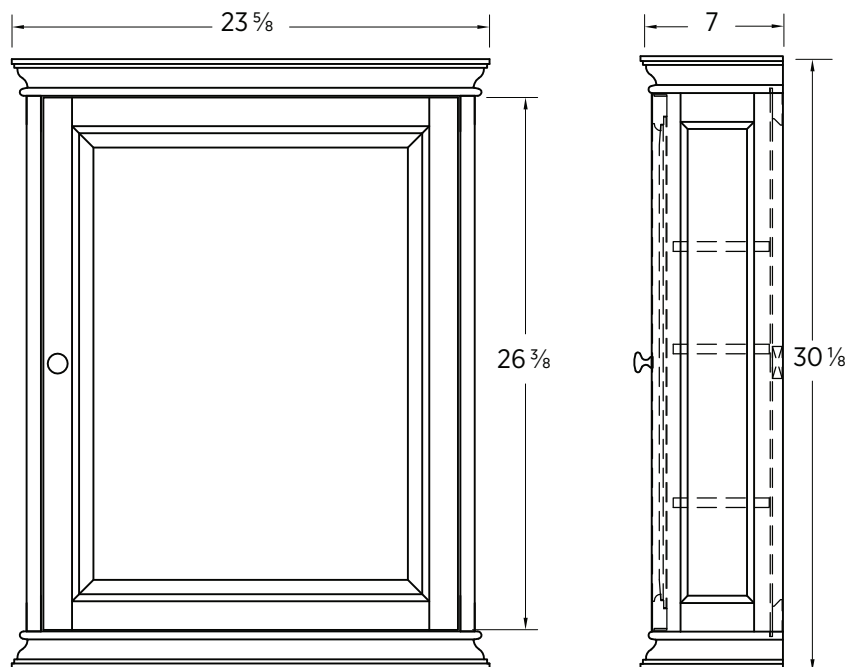

Important: Dimensions of each product are nominal and may vary within the range of tolerances allowed. These measurements are subject to change or cancellation. No responsibility is assumed for use of superseded or voided pages.

CARB
California Air Resources Board
California 93120.2(a) Compliant for Formaldehyde



Add to Smart Phone