

Instant Comfort...Endless Savings

Made In USA 

ELECTRIC TANKLESS WATER HEATERS

7/10

MODELS:

“STAGED” Models (Twin Module) Thermostatic Control

TC = Turns on in stages based on hot water demand.

Min. flow, 0.7 GPM, max 3 GPM

APPLICATIONS

- Multi fixture
- Residential Showers
- Commercial/Industrial
- Photo Processing
- Adjustable, Precise Temperature Setting +/- 1°F (ambient to 180°)
- Anti Scald Protection
- Solar backup

| Models | Options | Volts | kW | Amps |
|------------|---------|-------|--------|------------|
| EX120TC | FS,ML,S | 240V | 11.5kW | 48A |
| EX144 TC | FS,ML,S | 240V | 15kW | 64 (2x32)A |
| EX190TC | FS,ML,S | 240V | 19kW | 80 (2x40)A |
| EX023240TC | FS,ML,S | 240V | 23kW | 96 (2x48)A |
| EX1608TC | FS,ML,S | 208V | 16.6kW | 80 (2x40)A |
| EX160TC | FS,ML,S | 277V | 16kW | 58 (2x29)A |
| EX200TC | FS,ML,S | 277V | 20kW | 72 (2x36)A |

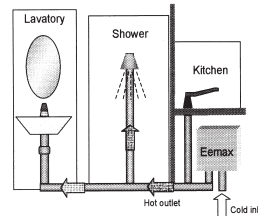

Multi Outlet



(T2)

THERMOSTATIC SPECIFICATION OPTIONS

- TC = Hot or cold water feed, “staged” turn on
- ML = Multi lavs .5 turn on. staged up to 4 lavs 105°-110° temp setting
- S = Sanitation 180°
- FS = Factory set ambient to 180°
- Nema 4 Enclosure (option)

“PARALLEL” Models (Twin Module) Thermostatic Control

T2 = Parallel turn on. Min. flow, 1.5 GPM, max 4 GPM

APPLICATIONS:

- Single high volume fixture
- Commercial Dishwashers
- Booster (Solar backup, jetted bathtub)
- Commercial/Industrial
- Adjustable, Precise Temperature Setting +/- 1°F (ambient up to 180°)
- Anti Scald Protection

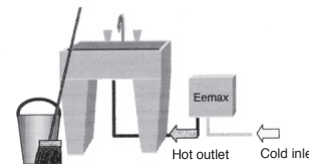

Mop Sink

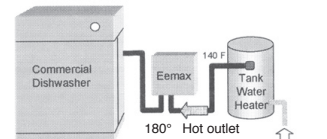

Booster



(TC)

THERMOSTATIC SPECIFICATION OPTIONS

- T2 = Hot or cold water feed “parallel” turn on
- EE = Emergency eye/face wash ANSI Z358.1 tepid water
- S = Sanitation 180°
- FS = Factory set ambient to 180°
- Nema 4 Enclosure (option)

Thermostatic

| Model | Options | Volts | kW | Amps |
|------------|---------|-------|--------|------------|
| EX120T2 | EE,S,FS | 240V | 11.5kW | 48A |
| EX144T2 | EE,S,FS | 240V | 15kW | 64 (2x32)A |
| EX190T2 | EE,S,FS | 240V | 19kW | 80 (2x40)A |
| EX023240T2 | EE,S,FS | 240V | 23kW | 96 (2x48)A |
| EX1608T2 | EE,S,FS | 208V | 16.6kW | 80 (2x40)A |
| EX160T2 | EE,S,FS | 277V | 16kW | 58 (2x29)A |
| EX200T2 | EE,S,FS | 277V | 20kW | 72 (2x36)A |

QUALITY FEATURES

- **On Demand Hot Water** - no delay.
- **Continuous Hot Water** - no storage capacity to run out.
- **Reduces Installation Cost** - no T&P relief valve needed (check local codes).
- **Easy Installation** - integral 3/4 npt fittings on bottom (no sweat connections).
- **Cut Energy Waste** - flow switch activates heater only on demand (no standby heat loss).
- **Anti Scald Protection(s)**
- **Meets ANSI Z358.1 tepid water requirement (T2EE)**
- **Reduces calcification.**
- **Ni Chrome Element** - a unique, patented flow path ensures optimum heat transfer and extended element life.
- **Compact Size** - dimensions; 10”x10.5”x3” weight 8 lbs
- **Field Serviceable Elements** - replaceable cartridge elements. (1 year warranty)
- **Designed for Durability; Warranty** - 1 year parts, 5 years leaks
- **Mounting** - Unit must be mounted on wall
- **High Temperature Limit Switch** - protects against element burn out, with reset button
- **LEED Certified**

SUGGESTED SPECIFICATION

Thermostatic Series Two

- Spec Options: T2 = Hot or cold water feed "parallel" turn on
 TC = Hot or cold water feed "staged" turn on
 EE = Tepid water 70° - 90° ANSI Z358.1 compliant (T2)
 S = Sanitation 180° (T2)
 ML = Multi lav temp setting 105° - 110° .5 GPM turn on up to 4 lavs
 FS = Factory set ambient to 180°
 Nema 4 enclosure (option)

Tankless Water Heater shall be an Eemax

"Series Two" Model _____ with _____ kW,
model # kW rating
 _____ vac, and _____ to heat _____ GPM
voltage amperage

@ a temperature rise of _____ degrees F. Heater shall have two heating modules. Element shall be replaceable cartridge insert. Unit shall have a replaceable filter in the inlet connector. Heater shall be fitted with 3/4 npt water connections. Maximum operating pressure of 150 psi. Hot water storage tanks prohibited. Unit shall be Eemax or approved equal.

NOTE: Refer to rating chart for product information.

SPECIFICATIONS:

Dimensions: 10" x 10.5" x 3"

Weight: 10.5 lbs.

Materials:

Cover: Enameled Steel.
 Glass Reinforced Heater Body and Ni Chrome Element

Color: White

Element: Dual replacement cartridge inserts

Pipe-Fittings: 3/4 npt fittings at bottom of unit.

Operating Pressure: min. 40 PSI, max 150 PSI

U.S. Patent #s: 4,960,976

4,762,980

UL Listing: E 36887(M)

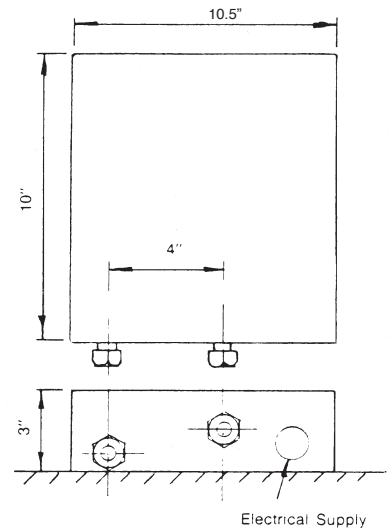

RATINGS OF "SERIES TWO" MODELS

"STAGED" Models (Twin Module)

With Thermostatic Control - Hot or cold water feed - "Staged" turn on, min flow .7 GPM, max 3 GPM

- TC = Hot or cold water feed "Staged" turn on
 FS = Factory set ambient to 180°
 ML = Multi lavs .5 turn on, staged up to 4 lavs 105°-110° temp setting
 S = Sanitation 180°

| MODEL | THERMOSTATIC OPTIONS | VOLTS | kW | AMPS | TEMPERATURE RISE °F | | | | Recommended WIRE SIZE |
|------------|----------------------|-------|--------|-------------|---------------------|--------|--------|--------|-----------------------|
| | | | | | 1.5GPM | 2.0GPM | 2.5GPM | 3.0GPM | |
| EX144TC | FS,ML,S | 240V | 15kW | 64 (2*x32)A | 68° | 51° | 41° | 34° | 8AWG per module |
| EX190TC | FS,ML,S | 240V | 19kW | 80 (2*x40)A | 87° | 65° | 52° | 43° | 8AWG per module |
| EX023240TC | FS,ML,S | 240V | 23kW | 96 (2*x48)A | 105° | 79° | 62° | 52° | 6AWG per module |
| EX1608TC | FS,ML,S | 208V | 16.6kW | 80 (2*x40)A | 75° | 57° | 45° | 38° | 8AWG per module |
| EX160TC | FS,ML,S | 277V | 16kW | 58 (2*x29)A | 73° | 55° | 44° | 36° | 10AWG per module |
| EX200TC | FS,ML,S | 277V | 20kW | 72 (2*x36)A | 91° | 68° | 54° | 46° | 8AWG per module |

"PARALLEL" Models (Twin Module)

With Thermostats Controls - Hot or Cold Water Feed - "Parallel" turn on - min flow 1.5 GPM, max 4 GPM

- T2 = Hot or cold feed "parallel" turn on
 FS = Factory set ambient to 180°
 EE = Emergency eye/face wash ANSI Z358.1 tepid water
 S = Sanitation 180°

| MODEL | THERMOSTATIC OPTIONS | VOLTS | kW | AMPS | TEMPERATURE RISE °F | | | | | Recommended WIRE SIZE |
|------------|----------------------|-------|--------|-------------|---------------------|--------|--------|--------|--------|-----------------------|
| | | | | | 1.5GPM | 2.0GPM | 2.5GPM | 3.0GPM | 4.0GPM | |
| EX144T2 | EE,S,FS | 240V | 15kW | 64 (2*x32)A | 68° | 51° | 41° | 34° | 25° | 8AWG per module |
| EX190T2 | EE,S,FS | 240V | 19kW | 80 (2*x40)A | 87° | 65° | 52° | 43° | 32° | 8AWG per module |
| EX023240T2 | EE,S,FS | 240V | 23kW | 96 (2*x48)A | 105° | 79° | 62° | 52° | 39° | 6AWG per module |
| EX1608T2 | EE,S,FS | 208V | 16.6kW | 80 (2*x40)A | 75° | 57° | 45° | 38° | 28° | 8AWG per module |
| EX160T2 | EE,S,FS | 277V | 16kW | 58 (2*x29)A | 73° | 55° | 44° | 36° | 27° | 10AWG per module |
| EX200T2 | EE,S,FS | 277V | 20kW | 72 (2*x36)A | 91° | 68° | 54° | 46° | 34° | 8AWG per module |

* The unit must have 2 independent electrical circuits using correctly rated wire and 2 circuit breakers.

SPECIAL DESIGN SERVICE INQUIRIES FOR UNITS FOR UNIQUE APPLICATIONS ARE WELCOME. CALL OUR TECHNICAL SERVICE DEPT. 1-800-543-6163.

EEMAX SUBMITTAL

Engineer/Architect: _____
 Job Name/Customer: _____
 Location: _____
 Contractor: _____
 Representative: _____
 HEATER SPECIFICATIONS:
 Series Two Model # EX _____ Option _____ Quantity _____ kW _____ Voltage _____ AMPS _____ GPM _____



www.eemax.com

353 CHRISTIAN STREET, OXFORD, CT 06478

Telephone: (203) 267-7890
 TOLL FREE: 1-800-543-6163
 FAX: (203) 267-7975

EX09001-11