

Handrinse basin # 070350..00 / 070350..08 / 070350..09

|< 19 5/8" Inch >|

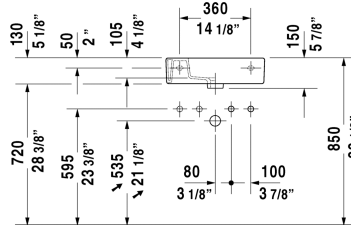
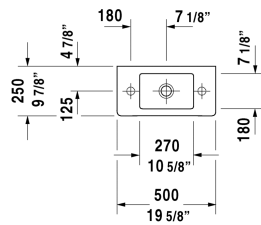

Handrinse basin	Dimension	Weight	Order number
with overflow, with tap platform, 19 5/8" Inch			
<b>Colors</b>			
00 White			
<b>Variant</b>			
# # pre-punched tap hole on left and right side	19 5/8" x 9 7/8" Inch	21.9 lb	070350..00
p tap hole on right side	19 5/8" x 9 7/8" Inch	21.9 lb	070350..08
p tap hole on left side	19 5/8" x 9 7/8" Inch	21.9 lb	070350..09
Sanitary ceramics with the special WonderGliss surface finish will remain clean and attractive-looking for a long time to come. When ordering WonderGliss please add a "1" as eleventh digit to the model number.			

All drawings contain the necessary measurements which are subject to standard tolerances. They are stated in inch & mm and are non-binding. Exact measurements, in particular for customized installation scenarios, can only be taken from the finished ceramic piece.