



CC7200 SERIES CONCRETE SAW

Turbo Charged Diesel Deep-Cut Saw

Features Deutz 78 HP turbo charged diesel engine
Also available with 65HP gasoline engine

22-3/4" cutting depth
with 54" guard

Jackshaft design for high torque,
lower RPM requirements for deep
sawing with large diameter blades

Forward-positioned motor
for more weight at blade
and less on the operator

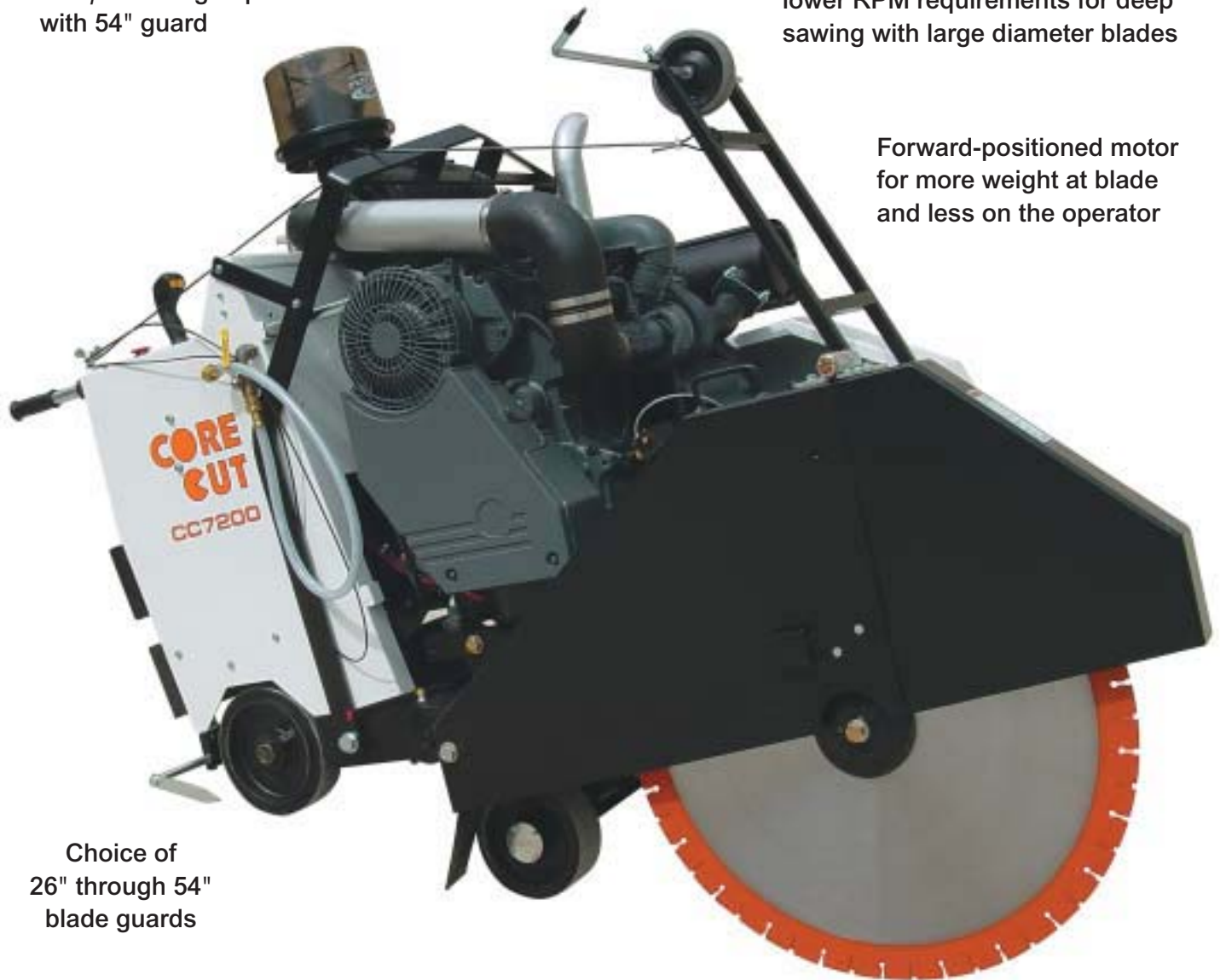

Choice of
26" through 54"
blade guards



Comes standard
with shaft tachometer

Optional 50 HP Baldor is the most powerful
electric saw in the industry

Extra heavy-duty reinforced single piece
frame designed for deep sawing

CC7200 SPECIFICATIONS



CC7200 Control Panel

Cutting Depth Chart

Blade Diameter	26"	30"	36"	42"	48"	54"
Cutting Depth	9-3/4"	11-3/4"	14-3/4"	16-3/4"	19-3/4"	22-3/4"

CC7200 Specifications

Maximum Depth of Cut: 22-3/4"
Blade Shaft Diameter: 1-3/4"
Arbor Diameter: 1" with Single Drive Pin
Blade Shaft Bearings: Self-aligning double concave roller
Blade Shaft Drive: 16 Belt Jackshaft, 10 Belt Engine
Blade Mounting: Right or Left
Blade Raise and Lower: Electro-hydraulic pump
Blade Coolant: Dual multi-spray tubes
Blade Guard Attachment: Slip-on through 30" guard, Bolt-on 36" and up
Front Wheel Dimensions: 8" x 3" x 1"
Rear Wheel Dimensions: 10" x 3" x 1-1/4"
Handle Bars: Tilt
Transmission: Eaton Model 10
Drive Speed: 0-200 feet per minute
Air Filter: 4 stage
Fuel Capacity: 9 gallons
Electric Start: Standard
High Temperature Shut-Off: Gauge and warning light alerts operator
Low Oil Alert: Warning light alerts operator
Hour Meter: Standard
Tachometer: Standard
Amp Meter: Warning light alerts operator
Cutting Depth Indicator: Standard
Quick Disconnect Blade Flanges: Standard
Quick Release Rear Wheels: Standard

CC7200 Saws

Model No.	Engine Type	P/N	Cat. No.	Blade Capacity	Uncrated Wt.*
CC7272-10-26	78 HP Deutz Diesel	5800176	48521	26"	2100 lbs.
CC7272-10-30	78 HP Deutz Diesel	5800177	48522	30"	2110
CC7272-10-36	78 HP Deutz Diesel	5800178	02308	36"	2120
CC7272-10-42	78 HP Deutz Diesel	5800179	02309	42"	2140
CC7272-10-48	78 HP Deutz Diesel	5800180	02310	48"	2160
CC7272-10-54	78 HP Deutz Diesel	5800181	02311	54"	2175
CC7265-10-26	65 HP Wisconsin	5800170	48523	26"	1735
CC7265-10-30	65 HP Wisconsin	5800171	48524	30"	1745
CC7265-10-36	65 HP Wisconsin	5800172	48525	36"	1755
CC7265-10-42	65 HP Wisconsin	5800173	02307	42"	1775
CC7265-10-48	65 HP Wisconsin	5800174	48526	48"	1795
CC7265-10-54	65 HP Wisconsin	5800175	48527	54"	1810
CC7250E-10-26	50 HP Baldor Electric (460V)	5800286	48528	26"	1735
CC7250E-10-30	50 HP Baldor Electric (460V)	5800287	48529	30"	1745
CC7250E-10-36	50 HP Baldor Electric (460V)	5800288	48530	36"	1755
CC7250E-10-42	50 HP Baldor Electric (460V)	5800289	48531	42"	1775
CC7250E-10-48	50 HP Baldor Electric (460V)	5800290	48532	48"	1795
CC7250E-10-54	50 HP Baldor Electric (460V)	5800291	02339	54"	1810

* add 150 pounds for crated weight.

CC7200 Options

Description	Part No.	Cat. No.
Water Safety Switch (diesel saw)	6010522	67821
Water Safety Switch (gas and electric saw)	6047932	47451
Water Pump (electric)	6011032	02506
Spot Light	6010112	02427
Magnetic Spot Light	6011170	47551
Vertical Muffler **	2700143	00587
Oil Cooler for 65HP Wisconsin	6010181	02460
Lowering Speed Metering Valve	6010227	02480
Soft Start Controller Add-On †	6010228	02481
Parking Brake	6011228	81191
Extra Blade Guards:		
26" Capacity (slip on)	6010074	02398
30" Capacity (slip on)	6010076	02399
36" Capacity	6010260	47088
42" Capacity	6010143	02442
48" Capacity	6010145	47091
54" Capacity	6010183	02461

** Standard on CC7272, Optional for CC7265 † For electric saws only - factory installed.

CC7200 Dimensions

A Saw Height	63"
B Min Length Pointer Up, Handle In	70"
C Max Length Pointer Down, Handle Out	135"
D Handle Extension	24"
E Frame Width (Rear)	27-5/8"
F Frame Width (Front)	37"
G Frame Length	60"
H Saw Width	43-1/4"
I Front Axle Center Length	31"
J Rear Axle Center Length	24-1/2"
K Wheel Base Length	25-3/8"
L Blade Shaft Max Height	28-1/2"

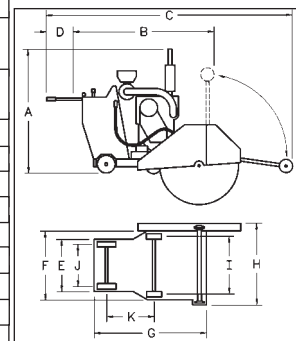

Crated Saw Dimensions:
80" long x 44" wide x 70" high