

Model/Modelo/Modèle

3584-DST

3587-DST

Series/Series/Seria

RP103724

Handle Indicator Rings
(1 Red, 1 Blue, 2 Gray & 2 Black)
Anillos indicadores del mango
(1 rojo, 1 azul, 2 grises y 2
negros)
Anneaux indicateurs de poignée
(1 rouge, 1 bleu, 2 gris et 2 noir)

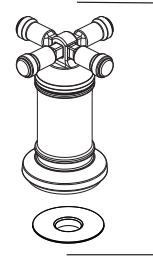
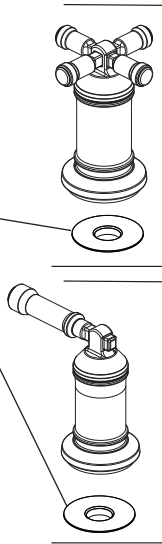

RP103725▲
Cross Handle Kit (2)
Ensamble de palanca (2)
Manette levier (2)

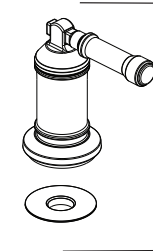

RP103723▲
Lever Handle Kit (2)
Ensamble de palanca (2)
Manette levier (2)

RP53429

Adapters (Not Included)
3/8"-24 UNEF to 1/2"-20 UN &
3/8"-24 UNEF to 1/2"-14 NPSM

Adaptadores (No incluido)
3/8"-24 UNEF to 1/2"-20 UN &
3/8"-24 UNEF to 1/2"-14 NPSM

Adaptateurs (non inclus)
3/8 po-24 UNEF to 1/2 po-20 UN et
3/8 po-24 UNEF to 1/2 po-14 NPSM



RP101953-1.2 (1.2 gpm)
RP101953-1.0 (1.0 gpm)
RP101953-0.5 (0.5 gpm)
Aerator & Wrench
Aireador y llave
Aérateur et clé

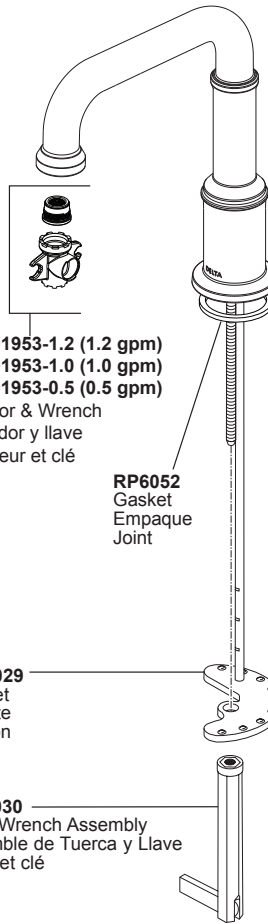

RP6052
Gasket
Empaque
Joint

RP47029
Bracket
Soporte
Fixation

RP47030
Nut & Wrench Assembly
Ensamble de Tuerca y Llave
Ecrou et clé

RP60352
Bonnet Nuts
Bonetes/Capuchones
Chapeaux Filetés

RP60400
Valve Assembly
Ensamble de la Válvula
Soupape

RP62378
End Valve Bushings (2)
Bujes de la válvula del
extremo (2)
Douilles de valve d'ex-
trémité (2)

RP100902
Mounting Hardware
Accesorios de montaje
Le matériel de montage

RP51243
Gaskets (2)
Empaques (2)
Joints (2)

RP50952
Plastic Sleeves
Mangas Plásticas
Manchons en plastique

RP101630▲
Metal Push Pop-Up
Ventana emergente de empuje de
metal
Pop-up Push en métal

RP101632▲
Metal Push Pop-Up Less Overflow
Ventana emergente de emergente
menos desbordamiento de metal
Pop-up Push Moins de débordement
en métal

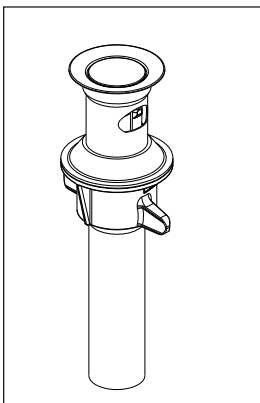

RP60457
Outlet Connector
Conexión de la salida
Raccord de sortie



▲ Specify Finish / Especificque el Acabado / Précisez le Fini