

Central Brass Company, Inc.
3325 S. Garfield Ave.
Commerce, CA 90040
(800) 321-8630
www.centralbrass.com

INSTALLATION

Tools:



Adjustable Wrench



Plumbers Putty



Teflon Tape



Rags

Model Number: 1645 Series

Warnings and Notes:

Check with local plumbing code requirements before installation.
This product should be installed by a local listed plumber.

Do not use plumbers putty on threads.



Installation Steps:

Multi-Tub Centrallift Lift & Turn Drain

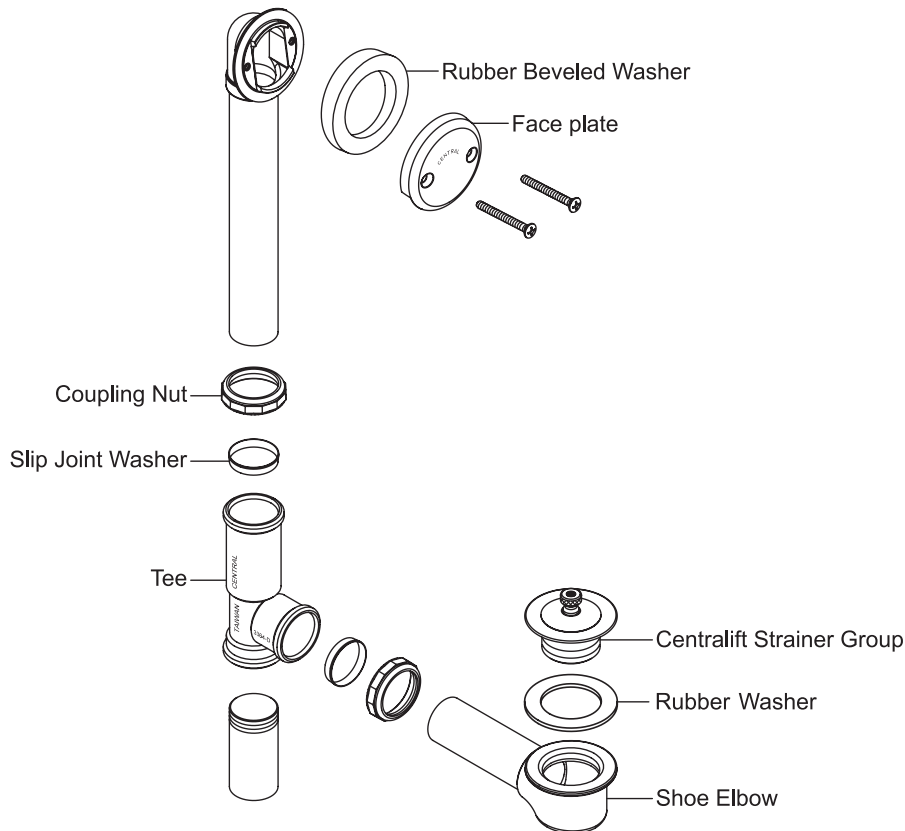

- (1) Apply a layer of plumbers putty to underside of strainer body, assemble in bathtub drain hole and screw tightly into shoe elbow as shown.
- (2) Assemble tubes with slip joint washers into tee as shown and screw on coupling nuts finger tight. Rotate rubber beveled washer on top ell to match angle of tub.
- (3) Screw in the two screws to hold face plate secure.
- (4) Tighten coupling nuts on tee with wrench to pull tapered slip joint washers securely into tee.
- (5) Assembly of a threaded tailpiece require the use of a thread sealant to prevent leakage.