

GX10

2" Spot / Pendant



FEATURES

- 2" round cylinder
- 1100 lm
- 90+ CRI
- Track, canopy, or pendant mount
- Black or white matte finish

MOUNTING

- ECO track / HALO® Power Trac Track and Juno® track
- Monopoint with field cuttable stem
- Field adjustable flexible cord pendant mounting option
- ECOH or ECOJ pendant mount option

ELECTRICAL/CONTROLS

- 120Vac, 50-60Hz input, 12W
- Phase dimmable
- Leading and trailing edge (Triac/ELV) dimming to 5%
- 350° rotation, 90° tilt

LISTING

- ETLus Listed to UL1574 (track suitable for dry locations only)
- cETL Listed to CSA C22.2 #9.0

LED INFO

- LED: Luminus CXM-9
- SDCM: 3-step MacAdam Ellipse
- Lumen Maintenance: L₇₀ > 55,000 hrs

PROJECT INFORMATION

JOB NAME		TYPE	
ORDERING CODE			

ORDERING CODE

SERIES	GX10		
DELIVERED LUMENS	11LM	1100LM	Calculated Delivered Lumens = [Delivered Lumen Value] x [CCT Multiplier]
CCT & LM MULTIPLIER	27K	2700K	(0.97)
	30K	3000K	(1.00)
	35K	3500K	(1.02)
CRI	90	90 CRI	
OPTIC & LM MULTIPLIER	25D	25 degrees	(0.94)
	35D	35 degrees	(0.98)
	50D	50 degrees	(1.00)
VOLTAGE	120	120V	
DIMMING	ELV	leading and trailing edge (Triac/ELV) dimming to 5%	
MOUNTING OPTIONS	P	pendant, 120" flexible cord	
	MP	monopoint canopy	
	ECOH	ECOH/HALO - Track	
	ECOJ ¹	ECOJ/JUNO - Track	
	ECOHP	ECOH/HALO pendant, 120" flexible cord	
	ECOJP ¹	ECOJ/JUNO pendant, 120" flexible cord	
FINISH	BK	black	
	WH	white	
ACCESSORIES	See the last page for details.		

Follow the steps to specify your fixture, example:
GX10 - 11LM - 30K - 90 - 35D - 120 - ELV - ECOJ - BK

NOTES

1. Adaptor designed with adjustable conductor for 2 circuit J-Type tracks.

PROJECT INFORMATION

JOB NAME		TYPE	
ORDERING CODE			

PHOTOMETRIC DATA

11LM CCT MULTIPLIERS	
	90CRI
2700K	0.97
3000K	1.00
3500K	1.02

FC Formula = CBCP / Distance²

25D 25.6° NO ACCESSORY	
Throw Distance (ft)	Beam Diameter (ft)
6	92
8	52
10	33
12	23
14	17
Illuminance at Center (fc)	
WATTS: 12	LPW: 87.3
LUMENS: 1047	CCT: 3000K
INTENSITY	
DEGREE	CANDELA
0	3320
5	2987
15	1304
25	387
35	174
45	78

35D 37.0° NO ACCESSORY	
Throw Distance (ft)	Beam Diameter (ft)
6	61
8	34
10	22
12	15
14	11
Illuminance at Center (fc)	
WATTS: 12	LPW: 92.5
LUMENS: 1110	CCT: 3000K
INTENSITY	
DEGREE	CANDELA
0	2199
5	2107
15	1412
25	639
35	212
45	64

50D 50.4° NO ACCESSORY	
Throw Distance (ft)	Beam Diameter (ft)
6	38
8	21
10	14
12	10
14	7
Illuminance at Center (fc)	
WATTS: 12	LPW: 92.8
LUMENS: 1114	CCT: 3000K
INTENSITY	
DEGREE	CANDELA
0	1369
5	1334
15	1081
25	695
35	319
45	127

11LM CCT MULTIPLIERS	
	90CRI
2700K	0.97
3000K	1.00
3500K	1.02

FC Formula = CBCP / Distance²

25D 25.6° SNOOT-BK	
Throw Distance (ft)	Beam Diameter (ft)
6	93
8	52
10	34
12	23
14	17
Illuminance at Center (fc)	
WATTS: 12	LPW: 76.4
LUMENS: 917	CCT: 3000K
INTENSITY	
DEGREE	CANDELA
0	3359
5	3027
15	1321
25	373
35	120
45	20

35D 37.4° SNOOT-BK	
Throw Distance (ft)	Beam Diameter (ft)
6	61
8	35
10	22
12	15
14	11
Illuminance at Center (fc)	
WATTS: 12	LPW: 82.2
LUMENS: 987	CCT: 3000K
INTENSITY	
DEGREE	CANDELA
0	2209
5	2124
15	1438
25	591
35	156
45	15

50D 47.8° SNOOT-BK	
Throw Distance (ft)	Beam Diameter (ft)
6	38
8	21
10	14
12	9
14	7
Illuminance at Center (fc)	
WATTS: 12	LPW: 71.7
LUMENS: 861	CCT: 3000K
INTENSITY	
DEGREE	CANDELA
0	1362
5	1330
15	1082
25	620
35	197
45	22

PROJECT INFORMATION

JOB NAME		TYPE	
ORDERING CODE			

MOUNTING OPTIONS

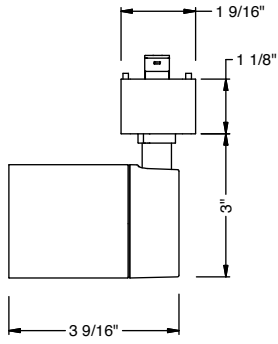

ECOH

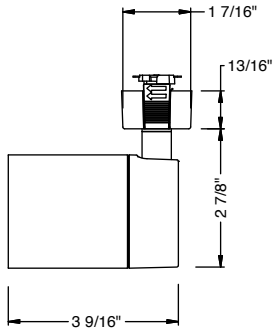

ECOJ

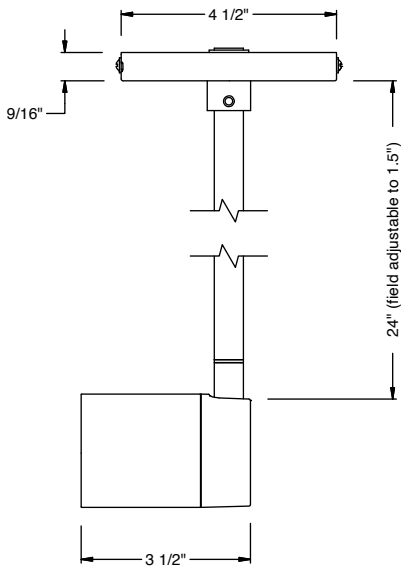
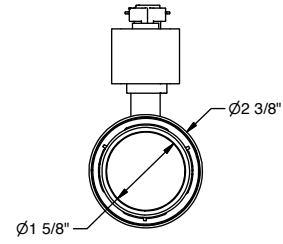

MONOPOINT

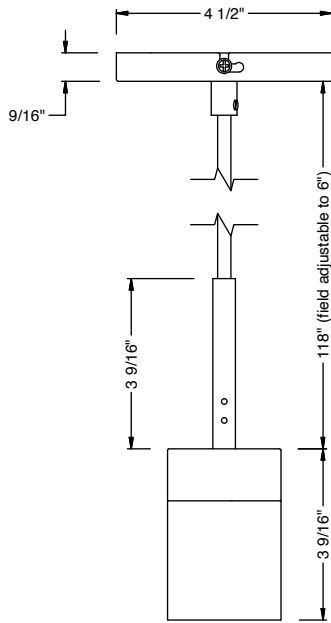

PENDANT

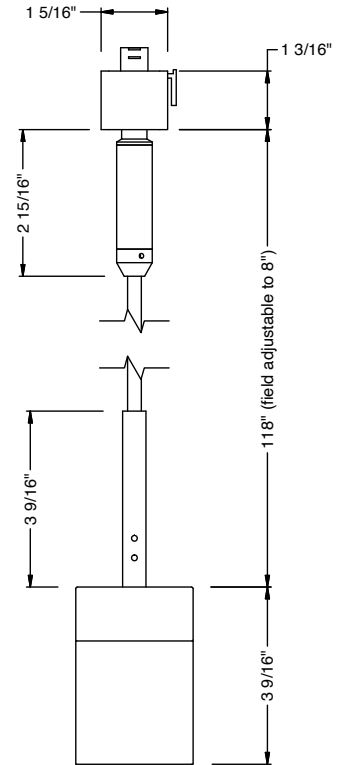

ECOHP / ECOJP

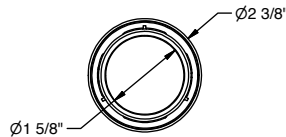

PROJECT INFORMATION			
JOB NAME		TYPE	
ORDERING CODE			

ACCESSORIES

Follow the steps to specify your fixture, example:

GX10 - 11LM - 30K - 90 - 35D - 120 - ELV - ECOH - BK - SNOOTBK

Accessories

- GX10-SNOOT-BK** snoot, black
- GX10-SNOOT-WH** snoot, white
- GX10-HCL-BK** honeycomb louver, black
- GX10-HCL-WH** honeycomb louver, white
- K20272/ECOMPBK** eco canopy, black
- K20272/ECOMPWH** eco canopy, white

NOTE: Omit GX10 from code when requesting accessory with fixture

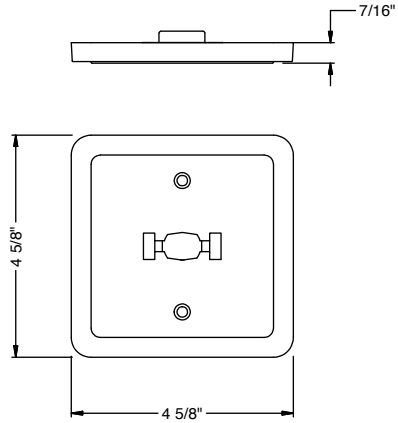

SNOOT

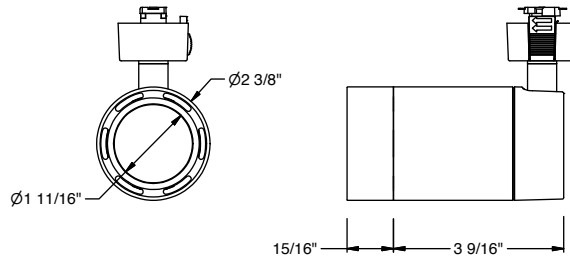

HONEYCOMB LOUVER

