

4

3

2

1

NOTES:

1. APPLY ADHESIVE LOCTITE 680 OR EQUIVALENT.

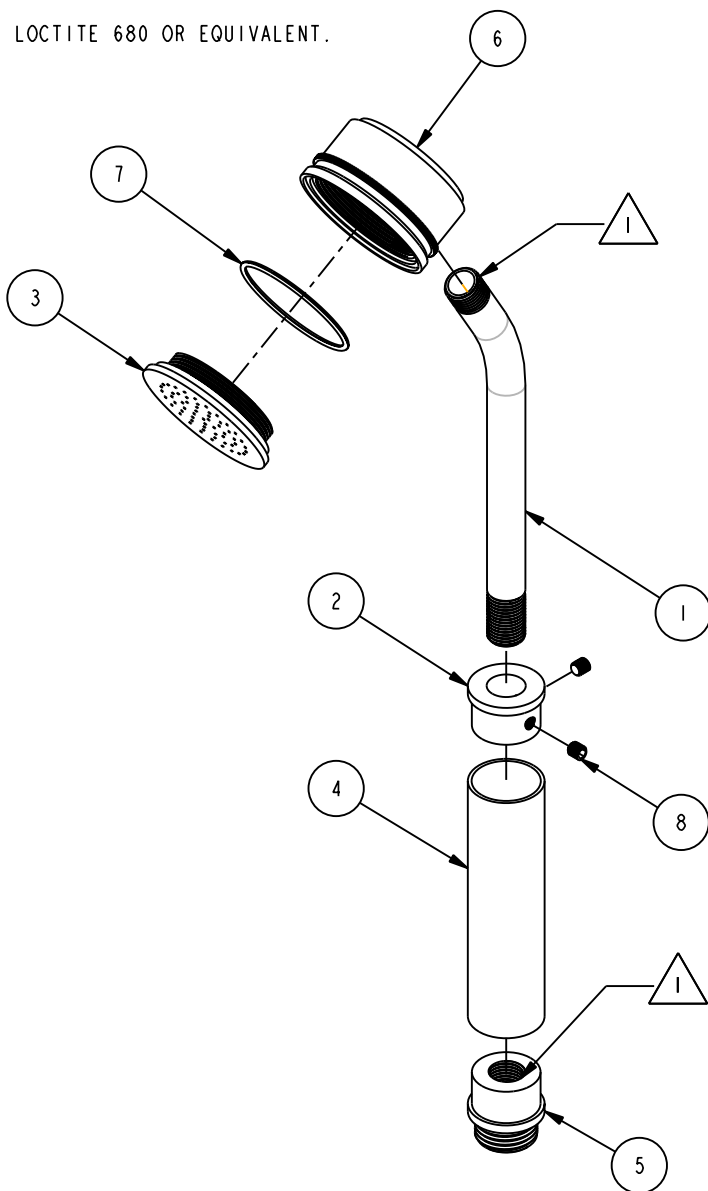

BILL OF MATERIAL (CURRENT LEVEL)

ITEM	PT/ASSY	DESCRIPTION	TYPE	QTY.
1	50486	TUBE STEM	PART	1
2	50487	HANDLE STOP	PART	1
3	50488	FACEPLATE	PART	1
4	50489	HANDLE	PART	1
5	50490	END NUT	PART	1
6	50697	HANDSHOWER BODY	PART	1
7	91159	O-RING #2-029	PART	1
8	92004	SET SCREW 10-32 X 3/16	PART	2

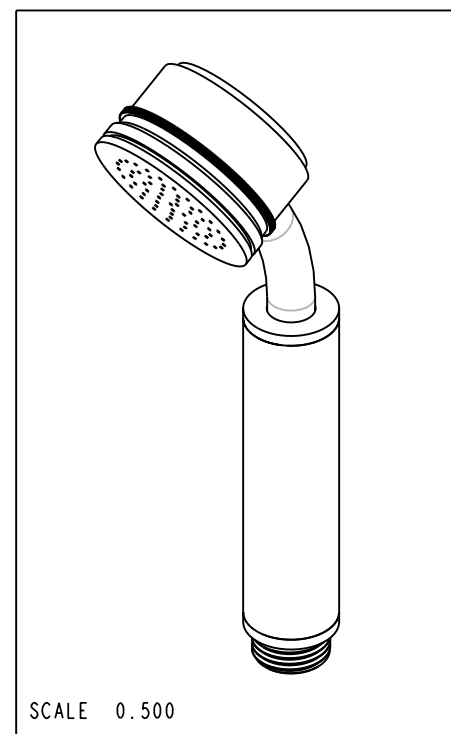

COPYRIGHT 2003 BRASSTECH, INC. THESE DRAWINGS AND THE DESIGNS DEPICTED HEREIN ARE THE PROPRIETARY PROPERTY OF BRASSTECH. ANY USE OR REPRODUCTION IS SUBJECT TO THE EXPRESS APPROVAL OF BRASSTECH. UNAUTHORIZED USE IS STRICTLY PROHIBITED. ALL RIGHTS RESERVED.

BRASSTECH
INCORPORATED
2001 E. CARNEGIE AVE.
SANTA ANA, CA 92705
(949) 417-5207

HAND SHOWER

ASSY. NO.		283-2					
SCALE 0.400		REF. -		SHEET OF		REV	
						EO-0357	
						05/20/04	
						DATE	

4

3

2

1

SPECIFICATION DWG

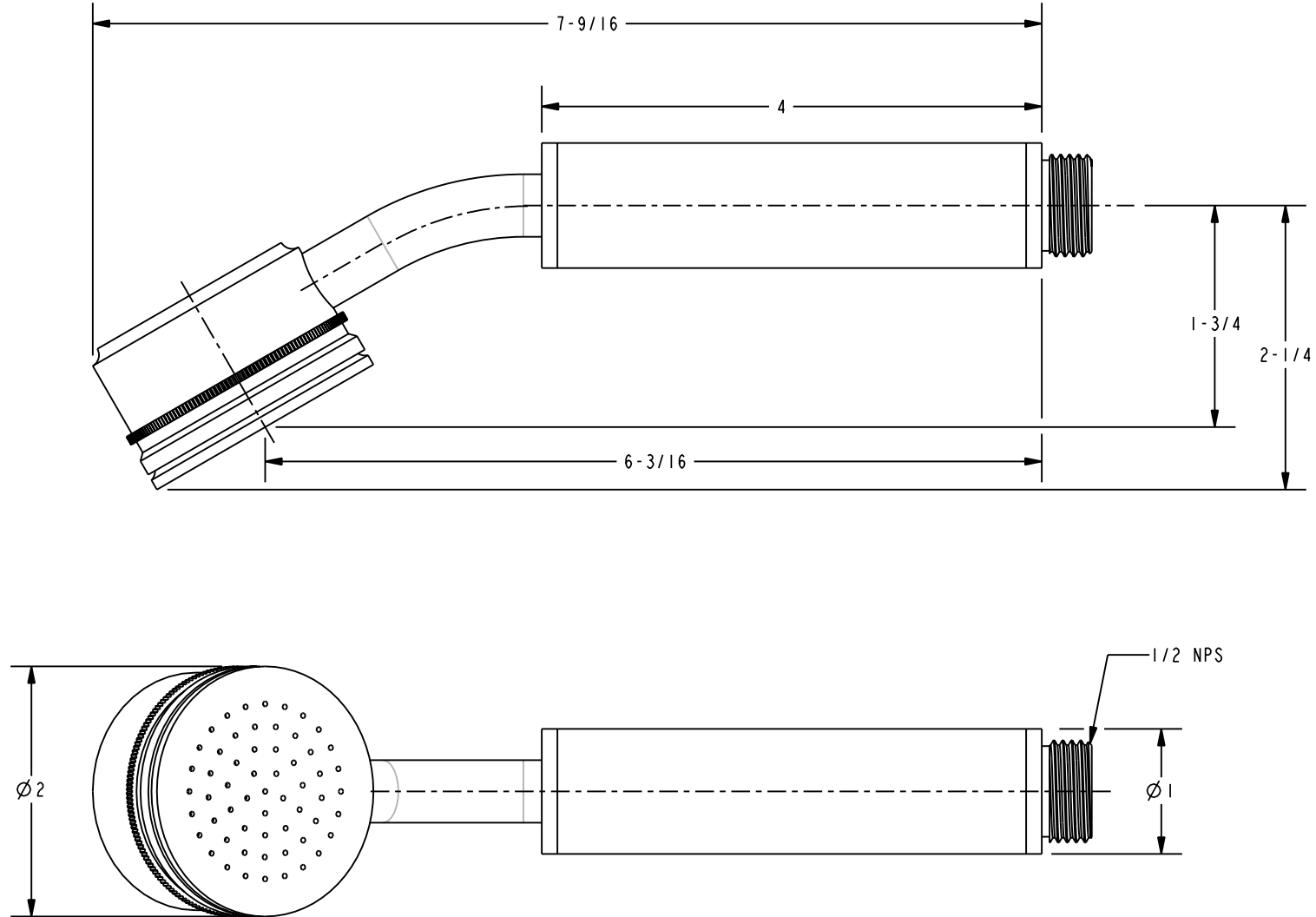

DIMENSIONS ARE IN INCHES AND AN APPROXIMATION OF A TYPICAL INSTALLATION

COPYRIGHT 2003 BRASSTECH, INC. THESE DRAWINGS AND THE DESIGNS DEPICTED HEREIN ARE THE PROPRIETARY PROPERTY OF BRASSTECH. ANY USE OR REPRODUCTION IS SUBJECT TO THE EXPRESS APPROVAL OF BRASSTECH. UNAUTHORIZED USE IS STRICTLY PROHIBITED. ALL RIGHTS RESERVED.

BRASSTECH
INCORPORATED
2001 E. CARNEGIE AVE.
SANTA ANA, CA 92705
(949) 417-5207

HAND SHOWER

ASSY. NO.		283-2_SPEC			
SCALE	0.750	REF.	-	SHEET	OF
REV		REV	DESC	DATE	

EO-0357 05/20/04