

Item	Part Number	Specifications	Dimensions
------	-------------	----------------	------------

## HINGES

**BR7023**  
3.5" 1/4" Radius



- 9BR7023-001** Venetian Bronze 112
- 9BR7023-002** Satin Nickel 150
- 9BR7023-003** Polished Chrome 260
- 9BR7023-004** Polished Brass 003
- 9BR7023-005** Matte Antique Nickel 152
- 9BR7023-006** Matte Brass & Black 049

- Solid brass construction designed for residential door applications
- Five knuckle, friction fit design with brass headed pin
- Non-rising pin with hole in bottom tip for easy removal

Care & Maintenance
<ul style="list-style-type: none"> <li>• Recommended to lubricate hinge pin with heavy bearing grease</li> <li>• To lubricate, extract pin and wipe or dip with grease. Reinsert pin. Grease will work into load bearing surface. Wipe excess grease and dirt from hinge</li> </ul>

**BR7024**  
3.5" 5/8" Radius



- 9BR7024-001** Venetian Bronze 112
- 9BR7024-002** Satin Nickel 150
- 9BR7024-003** Polished Chrome 260
- 9BR7024-004** Polished Brass 003
- 9BR7024-005** Matte Antique Nickel 152
- 9BR7024-006** Matte Brass & Black 049

- Available as a complete set with mounting hardware
- Ordered and packed one (1) hinge per box
- Hinges ship dry to prevent chemical contamination on doors or wood jambs before finishing

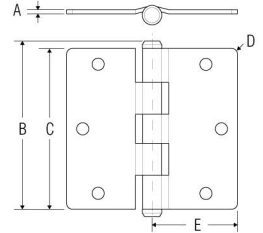

**BR7025**  
3.5" Square



- 9BR7025-001** Venetian Bronze 112
- 9BR7025-002** Satin Nickel 150
- 9BR7025-003** Polished Chrome 260
- 9BR7025-004** Polished Brass 003
- 9BR7025-005** Matte Antique Nickel 152
- 9BR7025-006** Matte Brass & Black 049

- 3.5" 1/4" Radius
- 3.5" 5/8" Radius
- 3.5" Square

A	B	C	D	E
.08"	3.82"	3.5"	.25"	1.86"
.08"	3.82"	3.5"	.625"	1.86"
.08"	3.83"	3.5"	N/A	1.86"

**BR7026**  
4" 1/4" Radius



- 9BR7026-001** Venetian Bronze 112
- 9BR7026-002** Satin Nickel 150
- 9BR7026-003** Polished Chrome 260
- 9BR7026-004** Polished Brass 003
- 9BR7026-005** Matte Antique Nickel 152
- 9BR7026-006** Matte Brass & Black 049

- Solid brass construction designed for residential door applications
- Five knuckle, friction fit design with brass headed pin
- Non-rising pin with hole in bottom tip for easy removal

Care & Maintenance
<ul style="list-style-type: none"> <li>• Recommended to lubricate hinge pin with heavy bearing grease</li> <li>• To lubricate, extract pin and wipe or dip with grease. Reinsert pin. Grease will work into load bearing surface. Wipe excess grease and dirt from hinge</li> </ul>

**BR7027**  
4" 5/8" Radius



- 9BR7027-001** Venetian Bronze 112
- 9BR7027-002** Satin Nickel 150
- 9BR7027-003** Polished Chrome 260
- 9BR7027-004** Polished Brass 003
- 9BR7027-005** Matte Antique Nickel 152
- 9BR7027-006** Matte Brass & Black 049

- Available as a complete set with mounting hardware
- Ordered and packed one (1) hinge per box
- Hinges ship dry to prevent chemical contamination on doors or wood jambs before finishing

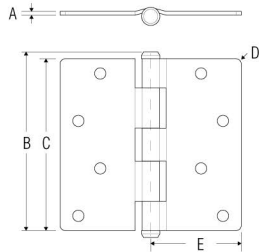

**BR7028**  
4" Square



- 9BR7028-001** Venetian Bronze 112
- 9BR7028-002** Satin Nickel 150
- 9BR7028-003** Polished Chrome 260
- 9BR7028-004** Polished Brass 003
- 9BR7028-005** Matte Antique Nickel 152
- 9BR7028-006** Matte Brass & Black 049

- 4" 1/4" Radius
- 4" 5/8" Radius
- 4" Square

A	B	C	D	E
.09"	4.32"	4"	.25"	2.11"
.09"	4.32"	4"	.625"	2.11"
.09"	4.32"	4"	N/A	2.11"

**BR7011**  
Hinge Pin Door Stop



- 9BR7011-001** Venetian Bronze 112
- 9BR7011-002** Satin Nickel 150
- 9BR7011-003** Polished Chrome 260
- 9BR7011-004** Polished Brass 003
- 9BR7011-005** Matte Antique Nickel 152
- 9BR7011-006** Matte Brass & Black 049

- Solid brass construction
- Adjustable to stop door at any angle with rubber pad making contact with door
- Hinge pin door stop can be used with Reserve hinges only. Not compatible with Baldwin Estate hinges.

