

American Standard

COPELAND DIVERTER TRIM KIT

Installation Instructions

T005.430

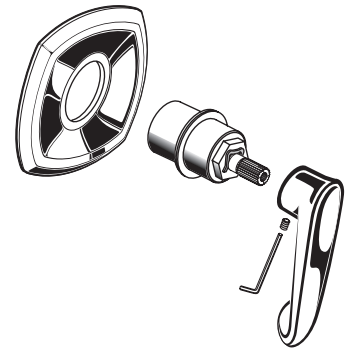

Thank you for selecting American-Standard...the benchmark of fine quality for over 100 years.

To ensure that your installation proceeds smoothly—please read these instructions carefully before you begin.

Certified to comply with ANSI A112.18.1

M968012_REV.1.1

ROUGHING-IN DIMENSIONS

ALL CONNECTIONS 1/2" NPT

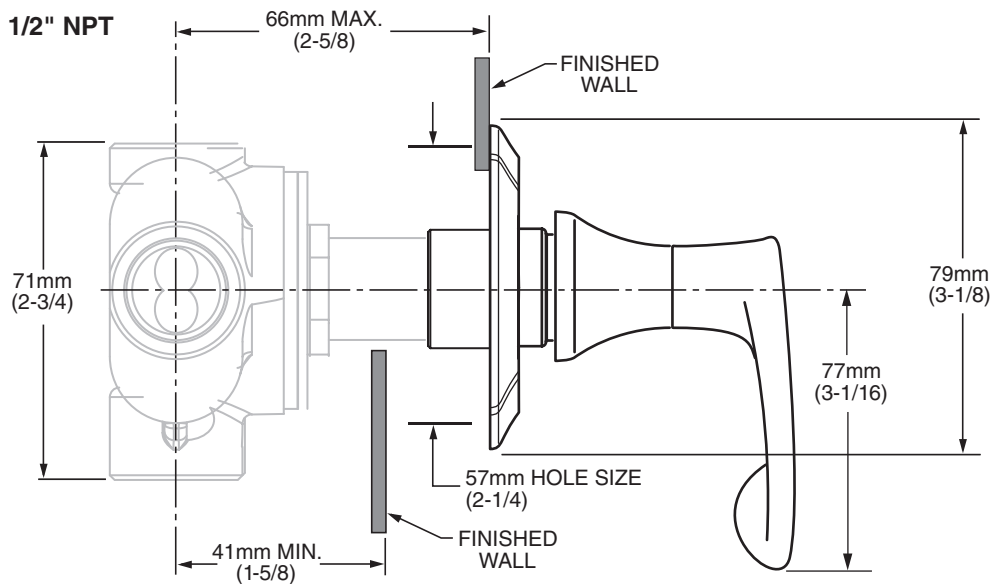

Recommended Tools

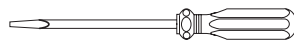

Flat Blade Screwdriver



Phillips Screwdriver

CARE INSTRUCTIONS:

- To keep your new faucet looking new, please follow these simple care instructions:

DO: ■ Simply rinse the faucet clean with clear water.
■ Dry the faucet with a soft cotton cloth.

DO NOT:

- Do not use any abrasive cleaners, cloths, or paper towels.
- Do not use any cleaning agents containing acids, polish abrasives, or harsh cleaners or soaps.

- Regular and routine cleaning will reduce the need for heavy cleaning and polishing. If heavy cleaning is required, the following procedures are recommended:

- Remove as much surface dirt and film using clear water and soft cotton cloth **(as described above)**.

- Use any of the following to remove tough surface film and build-up:

- Mild liquid detergents
- Clear ammonia free liquid glass cleaners
- Non-acidic, non-abrasive gentle liquid or fully dissolved powder cleansers mixed according to manufacturers directions.
- Non-abrasive liquid polishers

- Once clean, rinse faucet again with clear water to thoroughly remove cleaner or polish and blot dry with a soft cotton cloth.

Failure to follow these care instructions may damage the Faucet's finish.

1

TRIM INSTALLATION

- Place ESCUTCHEON **(1)** onto ESCUTCHEON HOLDER **(2)**.
- Align ESCUTCHEON **(1)**. Thread ESCUTCHEON HOLDER **(2)** onto DIVERTER VALVE **(3)**.
- Tighten until ESCUTCHEON **(1)** is snug against finished wall.

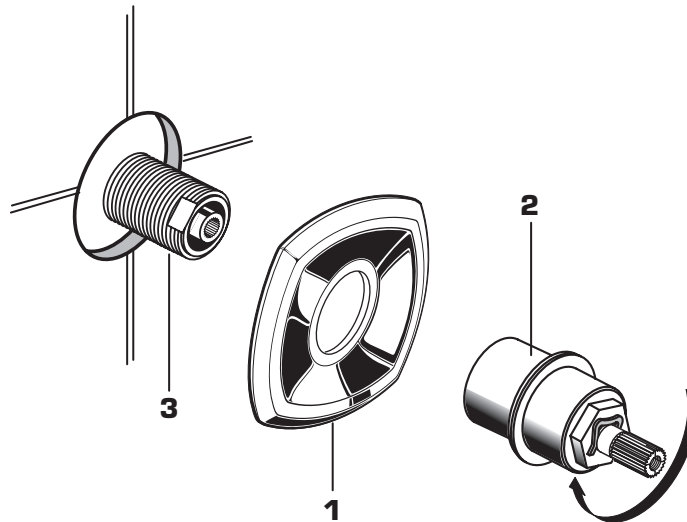

2

HANDLE INSTALLATION

- Install HANDLE ADAPTER **(1)** onto VALVE STEM **(2)**.
- Install HANDLE SCREW **(3)** and tighten.
- Push HANDLE BASE **(4)** onto HANDLE ADAPTER **(1)**.
- Align LEVER HANDLE **(7)** and push into HANDLE BASE **(4)**.
- Use HEX WRENCH **(5)** supplied and tighten SET SCREW **(6)** to secure HANDLE **(7)**.

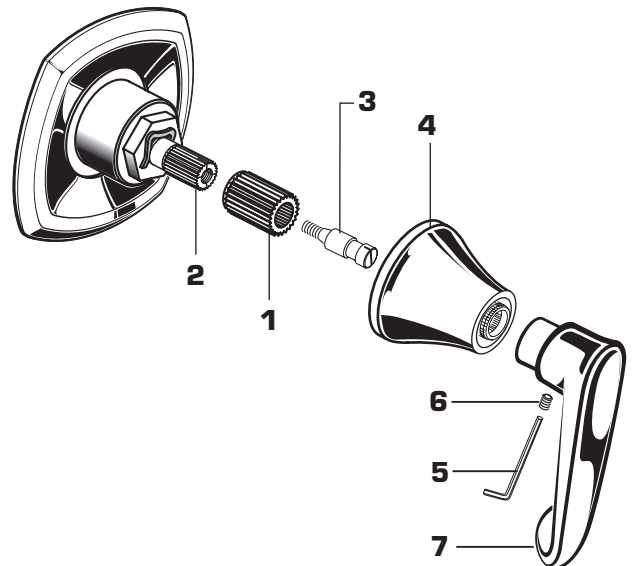

3

OPERATING THE VALVE

- Turn water supply on and test installed fitting.
- Rotate handle to all diverter positions to check operation of valve.
- Check for leaks.

