

Model No :: **62518LEDD-BS/ACR**
 Name :: **Arc**

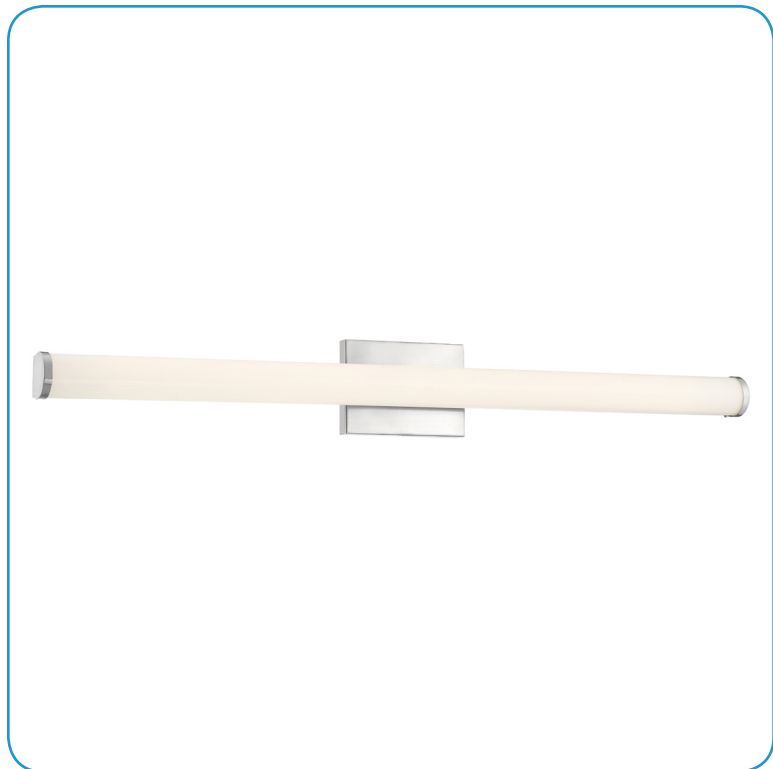

Project Name :: _____
 Location :: _____
 Type :: _____
 Quantity :: _____
 Notes :: _____

Product Information

Product ID :: 62518
 UPC Code :: 641594229103
 Mounting Type :: Wall
 Finish :: Brushed Steel (BS)
 Diffuser :: Acrylic Lens (ACR)
 Alt. Finishes :: N/A
 Alt. Diffusers :: N/A

Product Dimensions

| | | |
|-------------------|----------|-----------------|
| Fixture | | Canopy |
| Length :: | N/A | Length :: 0.75" |
| Width :: | 36" | Width :: 6.25" |
| Diameter :: | N/A | Diameter :: N/A |
| Extension :: | 2.625" | Height :: 4.5" |
| Height :: | 4.5" | |
| Overall Height :: | N/A Max. | |



Technical Specifications

Qualifications

Location Rating :: Damp
 Certification :: cETLus
 IES File :: No
 JA8 Compliant :: No
 Title 20 Compliant :: N/A
 Energy Star :: No
 ADA Compliant :: Yes
 Marine Grade :: No
 Emergency Lighting :: No
 Warranty :: 5 Year Limited

Specifications

Frame Material :: Metal
 Diffuser Material :: Acrylic
 Voltage :: 120v
 Lamping Type :: Dedicated LED
 Lamping Base :: SSL
 Lamp Quantity :: 1
 Lamp Wattage :: 30 W
 Total Wattage :: 30 W
 Lamps Included :: Yes
 J-Box Type :: Standard

Photometrics

CCT :: 3000
 CRI :: 90
 Wattage :: 30 W
 Nominal Lumens :: 2800
 Delivered Lumens :: N/A

Recommended Dimmers

(ELV) LUTRON Caseta PD - 6WCL; (ELV) LUTRON Maestro CL MACL-153M; (ELV) LUTRON Maestro MRF2-6CL; (TRIAC) LUTRON Diva DVCL-153P

Custom Options :: N/A; Additional Items :: N/A

Line Drawing #1

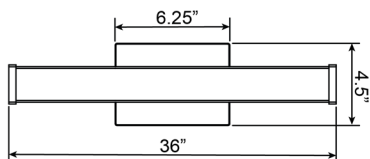

Line Drawing #2

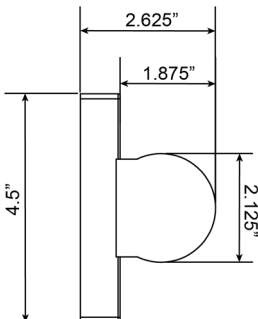

IES File

Image Not Available

Toll Free 800-828-5483 or www.AccessLighting.com

14410 Myford Road, Irvine, CA 92606

The information provided is subject to change without notice. ©2018 Access Lighting Corporation. All Rights Reserved
 Rev. 201901 Filename:: 62518LEDD-BS_ACR.pdf

